

**TYPICAL CLADDING LAYOUT - WET JOINT SYSTEM**

**ROOF SYSTEMS™** **BELCO LIFT** **Gbi**  
EXPERIENCE WINDOWS & DOORS  
**MORE than just roofing**  
 TEL: 1(868) 285-9164 [www.roofsystemstt.com](http://www.roofsystemstt.com)

Drawn: XXX	CLADDING DETAILS		
Scale: NTS	Detail: DETAILS		
Dwg. Chk. XXX	Dwg. No.		
Date: 01/01/2019	001		
	Job. No.	Sheet No.	Rev.

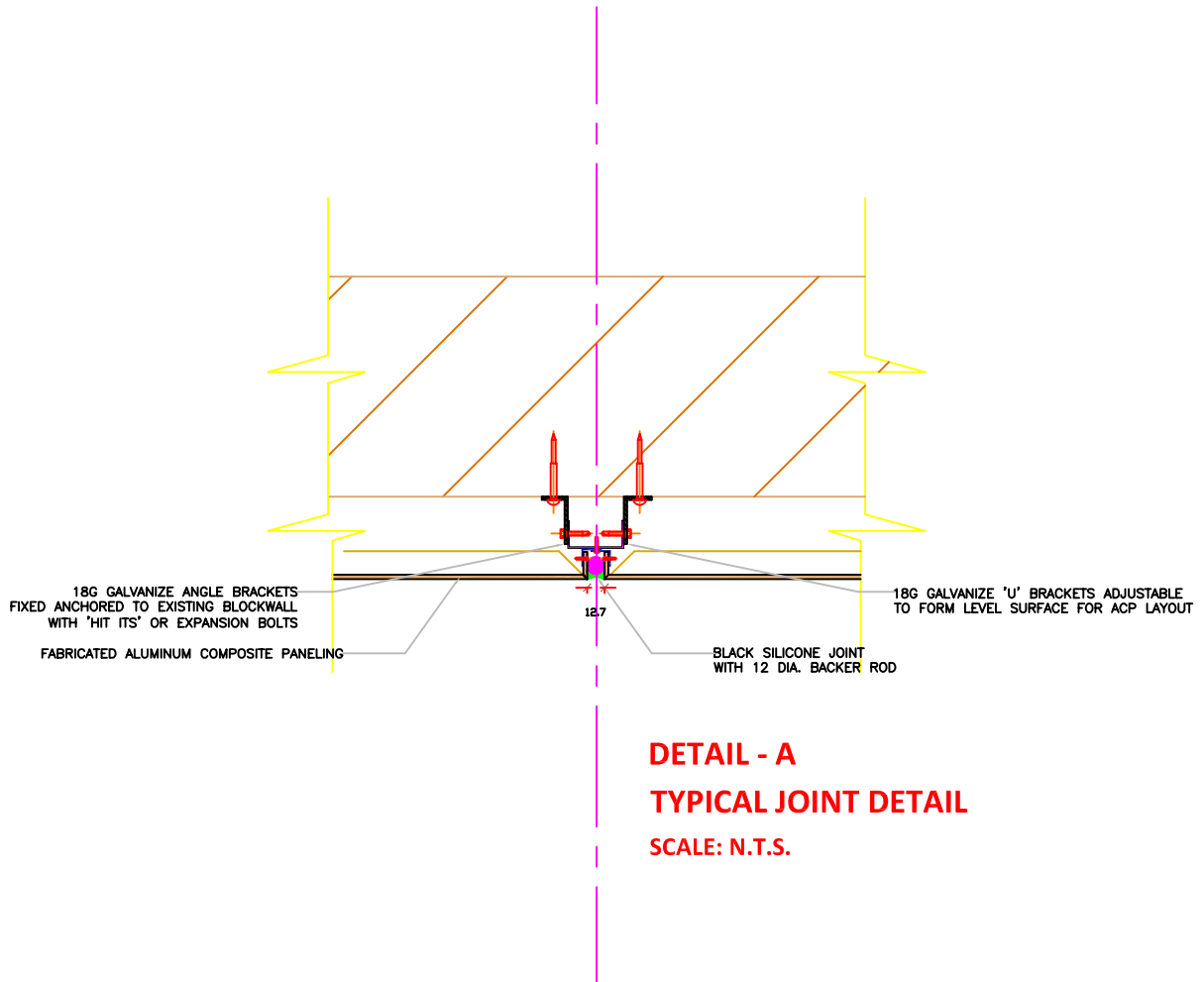





**ROOF SYSTEMS** MORE than just roofing

TEL: 1(868) 285-9164 [www.roofsystemstt.com](http://www.roofsystemstt.com)

Drawn: XXX	CLADDING DETAILS		
Scale: NTS	Detail: DETAILS		
Dwg. Chk. XXX	Dwg. No.		
Date: 01/01/2019	001		
	Job. No.	Sheet No.	Rev.

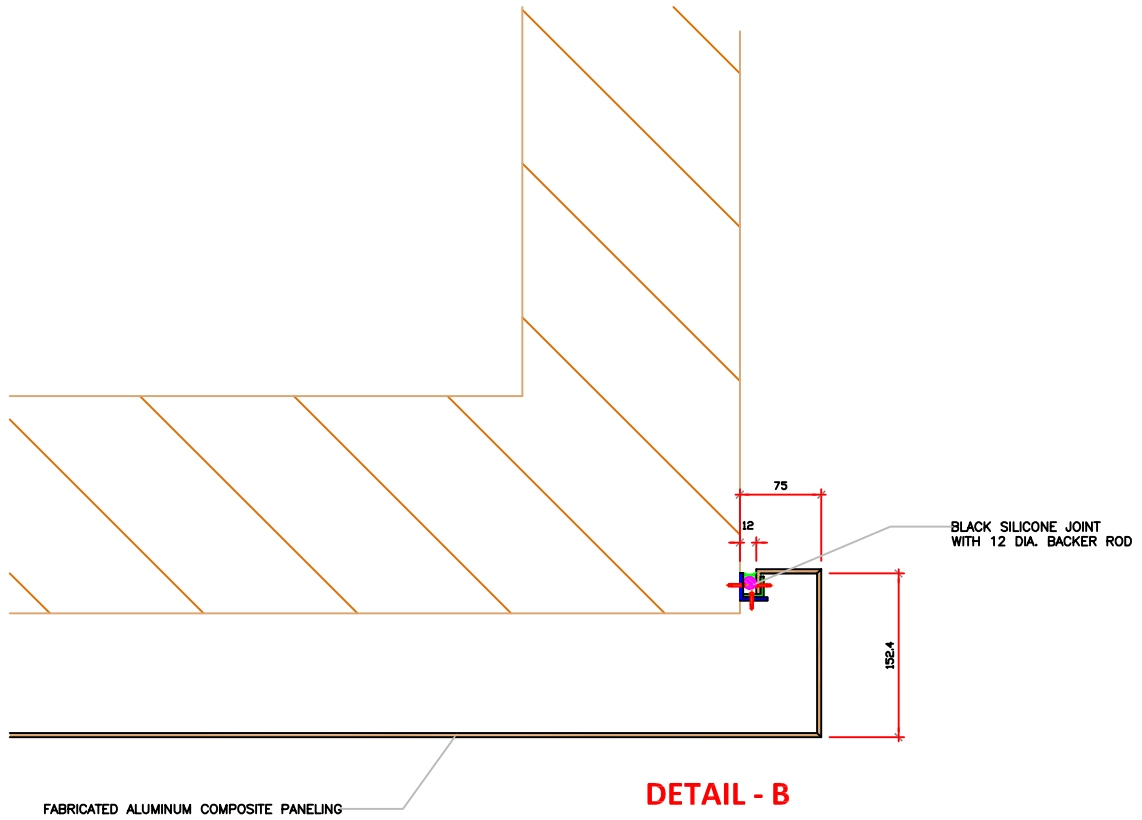

**DETAIL - B**  
**TYPICAL END DETAIL**  
**SCALE: N.T.S.**

**ROOF SYSTEMS**  
**RELLCO LIFT**  
**UP**  
**GI**  
**MORE than just roofing**  
**TEL: 1(868) 285-9164 www.roofsystemstt.com**

Drawn: XXX	CLADDING DETAILS		
Scale: NTS	Detail: DETAILS		
Dwg. Chk. XXX	Dwg. No.		
Date: 01/01/2019	001		
	Job. No.	Sheet No.	Rev.

ACP CAPPING  
SIZE VARIES AS REQUIRED

16G ALUMINUM WATER PROOFING

BLACK SILICONE JOINT  
WITH 12 DIA. BACKER ROD

16G GALVANIZE ANGLE BRACKETS  
ANCHORED ON EXISTING BASEWALL

25 X 50 X 25 18G GALVANIZED  
'U' SHAPED SUB-FRAME

WEEP HOLES

16G GALVANIZE ANGLE BRACKETS  
FIXED ANCHORED TO EXISTING BLOCKWALL  
WITH 'HIT ITS' OR EXPANSION BOLTS

BLOCKWALL  
BY OTHERS

**DETAIL - C**  
**TYPICAL PARAPET DETAIL**  
**SCALE: N.T.S.**



**ROOF SYSTEMS** MORE than just roofing  
**RELCO** **LIFT** **GGI**  
 TEL: 1(868) 285-9164 www.roofsystemstt.com

Drawn: XXX	CLADDING DETAILS		
Scale: NTS	Detail: DETAILS		
Dwg. Chk. XXX	Dwg. No.		
Date: 01/01/2019	001		
	Job. No.	Sheet No.	Rev.